

# International Exchange Workshop Towards Architecture and Urban Design for Asian Cities Tokyo 2015

Shibaura Institute of Technology Department of Engineering and Design

King Mongkut's University of Technology Thonburi School of Architecture and Design



Kita-shinagawa, study area

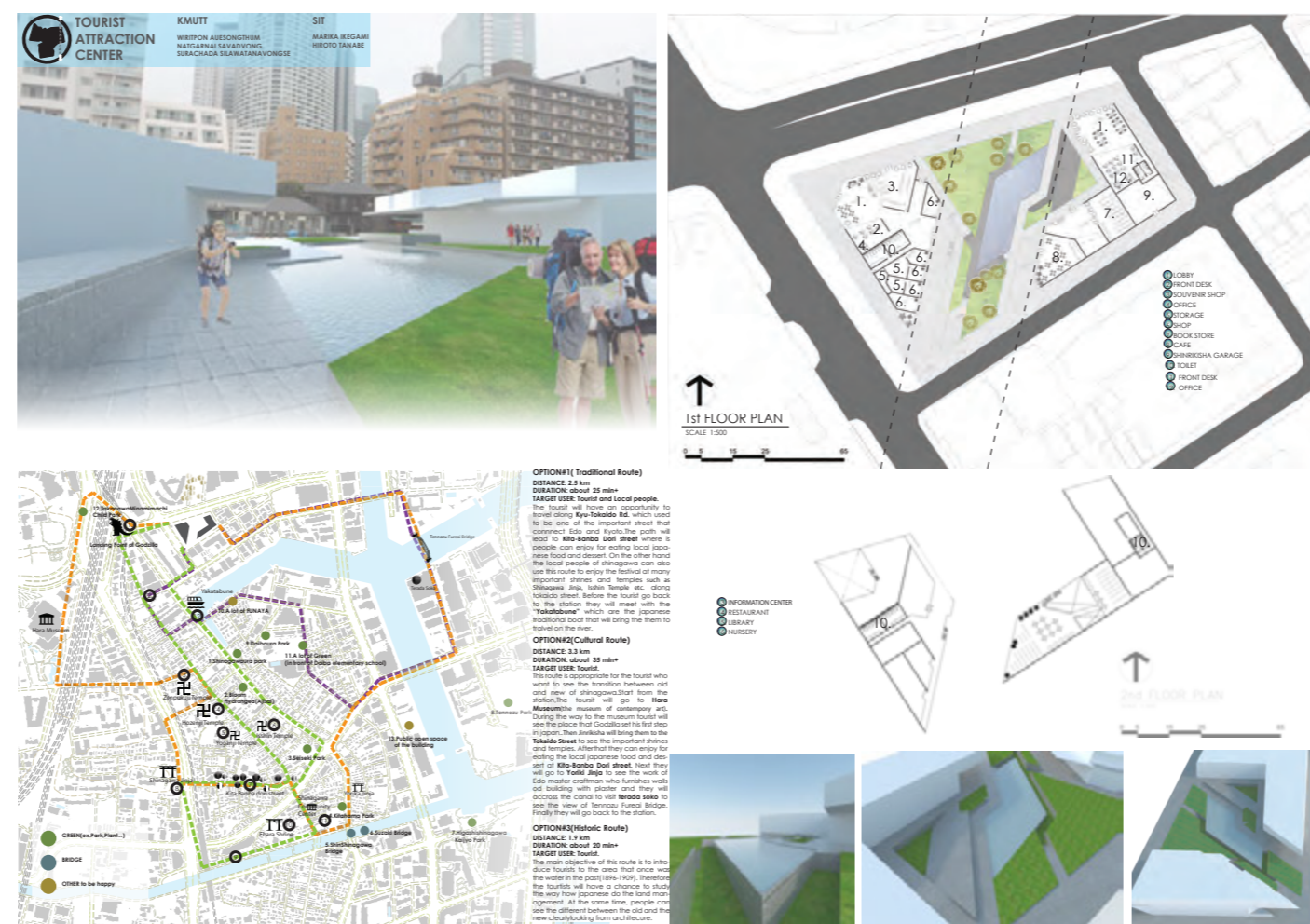

Group 1



Site visit



SIT and KMUTT

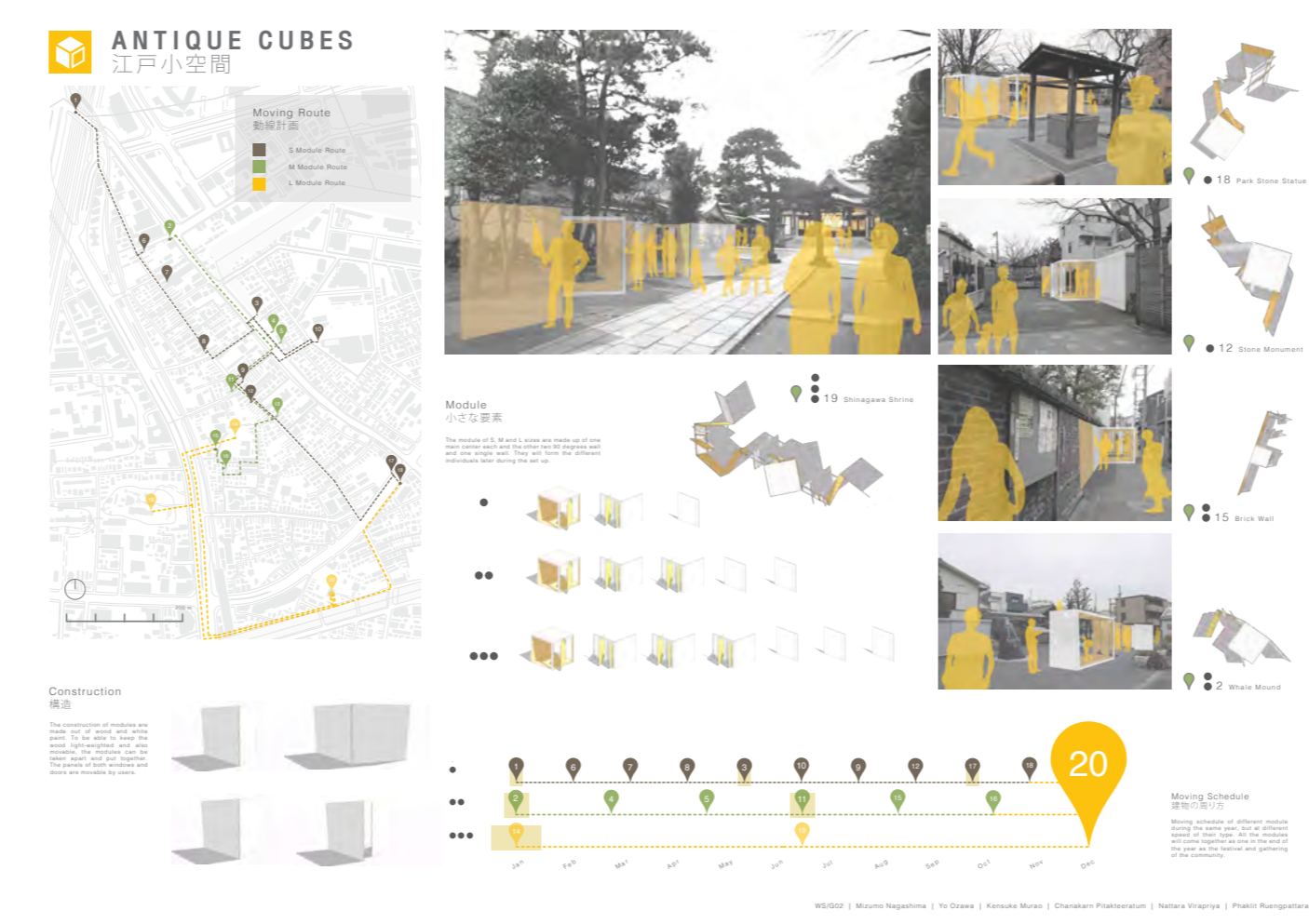

Group 2



One-day trip to Kawagoe



Studio work



Group 3



Presentation

Shibaura Institute of Technology (SIT) Department of Engineering and Design held the fourth program of International Exchange Workshop of Architecture and Urban Design in Tokyo 2015 December with King Mongkut's University of Technology Thonburi (KMUTT) School of Architecture and Design, after the first and second with Chung-Ang University (CAU) School of Architecture and Building Science in Seoul 2012 and Tokyo 2014, and the third with Universiti Teknologi Malaysia (UTM) Department of Landscape Architecture in Johor Bahru 2015 September. Eight SIT graduate and nine KMUTT 4th-year students collaborated eight days in three mixed groups exploring creative conservation of Kita-shinagawa, a waterfront area between Tokyo heart and harbor. DAY 1- Introductory session and site visit. Day 2- One-day trip to Kawagoe conservation district. Day 3- SIT professor Maeda's lecture on Tokyo. Day 4 and 5- Studio work. Day 6- Intermediate critic and KMUTT professor Sunaree's lecture on Bangkok. Day 7- Japanese culture workshop. Day 8- Final presentation.

SIT staff- Hidetoshi Maeda, Prof. and Reiko Kageyama, International Division

KMUTT staff- Sunaree Lawanyawatna, Design Lecturer